

5.25 ACRES

DESCRIPTION

A parcel of land located in the Southwest one-quarter (SW¹/₄) of the Southeast one-quarter (SE¹/₄) of Section 30, T.31N., R.12E., Town of Polar, Langlade County, Wisconsin, being more particularly described as follows;

Commencing at the South one-quarter (S¹/₄) of Section 30, T.31N., R.12E., Town of Polar, Langlade County, Wisconsin, Thence N90°-00'-00"E, along the South Section Line of said Section 30, 185.18 feet, to the Point of Beginning, Thence continuing N90°-00'-00"E, along the South Section Line, 425.00 feet, Thence N4°-21'-20"E, 553.40 feet, Thence S90°-00'-00"W, 306.34 feet, Thence S52°-07'-20"W, 159.80 feet, Thence S4°-21'-20"W, 455.00 feet to the Point of Beginning. Except Road Right of Way for Crestwood Road.

I, Gary A. Radtke, Registered Land Surveyor, certify that I made such survey and map under the direction of Mr. Joseph McKenna owner of said land. That the map is a correct representation of all exterior boundaries of the survey.

Gary A. Radtke
GARY A. RADTKE S-1248

Dated 29Mar77

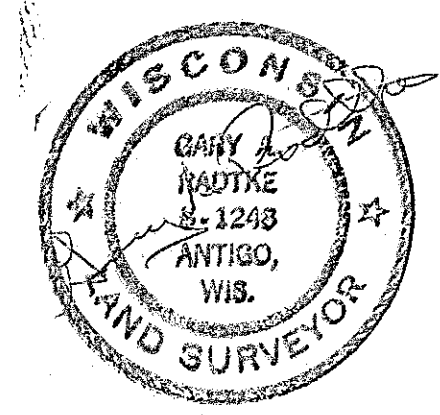

LOCATION SKETCH

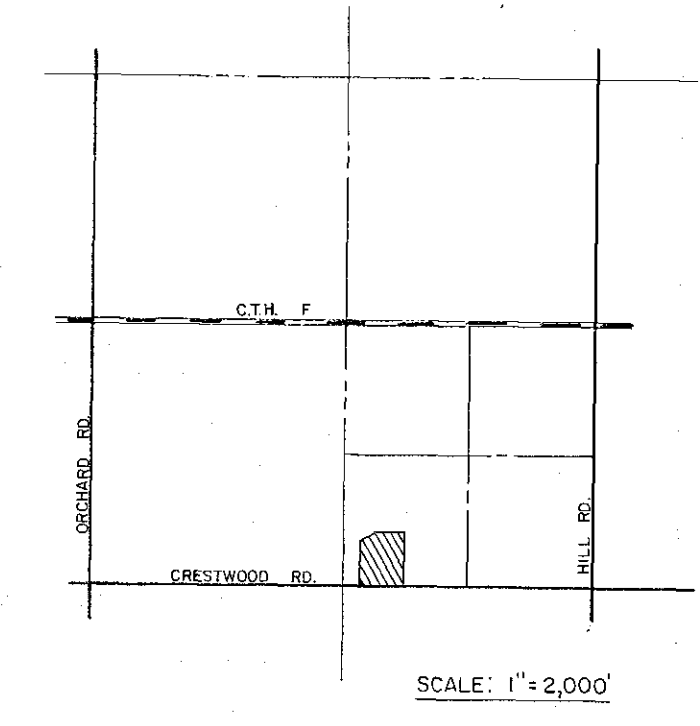

SECTION 30 T.31N.-R.12E.
LANGLADE CO., WISCONSIN

RECORD # 30082
LANGLADE COUNTY SURVEYORS OFFICE
DATE FILED: 5/24/93 BY: D.T.

DYNAMIC ENGINEERING / SURVEYING INC.			
SCALE	" = 60'	REVISIONS	BY DATE
DATE	29 MAR 77		
DR. N.	DTK	CKD.	
AP. VD.			
TITLE	NO.		
J. McKENNA	587		