



N.W. COR. OF SEC. 15

1459.93'  
N.90°-00'-00" E.

NICKLE ROAD

OLD 26

33.00'  
S.0°-18'-00" W.

P.O.B.

S.90°-00'-00" W.  
2087.1'

S.0°-18'-00" W.  
280.50'

N.0°-18'-00" W.  
280.50'

208.71'  
N.90°-00'-00" E.

DESCRIPTION

A parcel of land located in the Northeast one-quarter (NE $\frac{1}{4}$ ) of the Northwest one-quarter (NW $\frac{1}{4}$ ) of Section 15, T.30N., R.11E., Town of Rolling, Langlade County, Wisconsin, being more particularly described as follows;

Commencing at the Northwest (NW) Corner of said Section 15, T.30N., R.11E., Town of Rolling, Langlade County, Wisconsin, Thence N90°-00'-00"E along the North Section Line of said Section 15, 1459.93 feet, Thence S0°-18'-00"E, 33.00 feet to the South Right of Way Line of Nickle Road and the Point of Beginning, Thence S0°-18'-00"E, 280.50 feet, Thence N90°-00'-00"E, 208.71 feet, Thence N0°-18'-00"W, 280.50 feet to the South Right of Way Line of Nickle Road, Thence S90°-00'-00"W along the South Right of Way Line of Nickle Road, 208.71 feet to the Point of Beginning.

I, Gary A. Radtke, Registered Land Surveyor, certify that I made such map and survey under the direction of Mr. Roy Thompson owner of said land. That the map is a correct representation of all exterior boundaries of the survey.

*Gary A. Radtke*  
GARY A. RADTKE S-1248

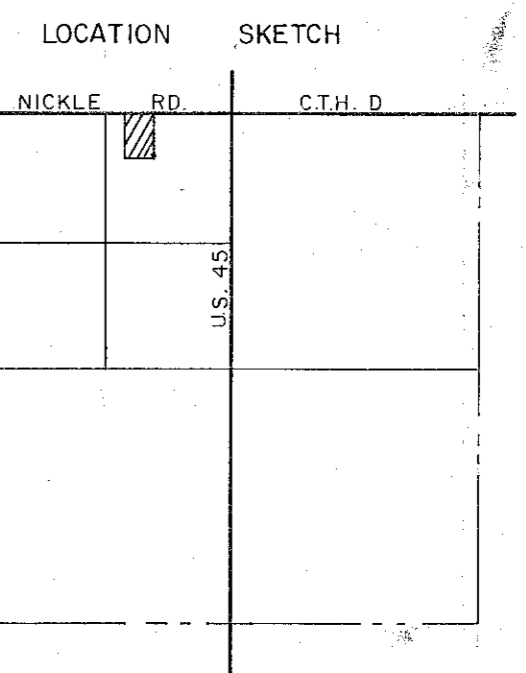

SECTION 15 T.30N - R.11E  
TOWN OF ROLLING

RECORD # 30086  
LANGLADE COUNTY SURVEYORS OFFICE  
DATE FILED: 5/24/93 BY: D.T.



DYNAMIC ENGINEERING - SURVEYING			
SCALE	REVISIONS	BY	DATE
1" = 40'			
DATE			
3-16-77			
DR'N.	CHKD.		
D.T.K.			
AP'VD.			
TITLE	NO.		
THOMPSON	579		

BRUNING 0-105