

Recorded Description

A parcel of land in the NW $\frac{1}{4}$  of the NE $\frac{1}{4}$  of Sec. 12, Township 30 North, Range 11 East, described as follows: Starting at the Southwest corner of said 40 acres, thence North along west line of said 40 acres a distance of 573 feet to point of beginning; thence North along west line of said 40 acres a distance of 208 feet; thence East 417 feet to a stake; thence south parallel to west line of said 40 a distance of 208 feet; thence West to point of beginning.

Proposed DESCRIPTION

A parcel of land located in the Northwest one-quarter (NW $\frac{1}{4}$ ) of the Northeast one-quarter (NE $\frac{1}{4}$ ) of Section 12, Township 30 North, Range 11 East, Town of Rolling, Langlade County, Wisconsin, and being more particularly described as follows:

Commencing at the Southwest (SW) corner of the Northwest one-quarter (NW $\frac{1}{4}$ ) of the Northeast one-quarter (NE $\frac{1}{4}$ ) of Section 12, T30N, R11E, Town of Rolling, Langlade County, Wisconsin; THENCE N0°00'00"E along the west line of the NW $\frac{1}{4}$  of said Section 12 which is the center line of Maple Road, 573.00 feet; THENCE S87°50'40"E, 33.02 feet to the east line of Maple Road and the point of beginning; THENCE N0°00'00"E along the east line of Maple Road, 208.00 feet; THENCE S87°50'40"E, 383.98 feet; THENCE S0°00'00"W, 208.00 feet; THENCE N87°50'40"W, 383.98 feet to the point of beginning.

I, Gary A. Radtke, Registered Land Surveyor certify that I made such survey and map under the direction of Mr. Ronald Arndt, the owner of said land. That the map is a correct representation of all exterior boundaries of the survey. Dated: March 2, 1976

*Gary A. Radtke*  
Gary A. Radtke, S-1248

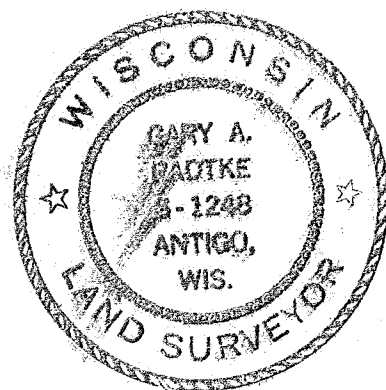

SECTION 12 T.30N.  
R.11E. TOWN OF ROLLING

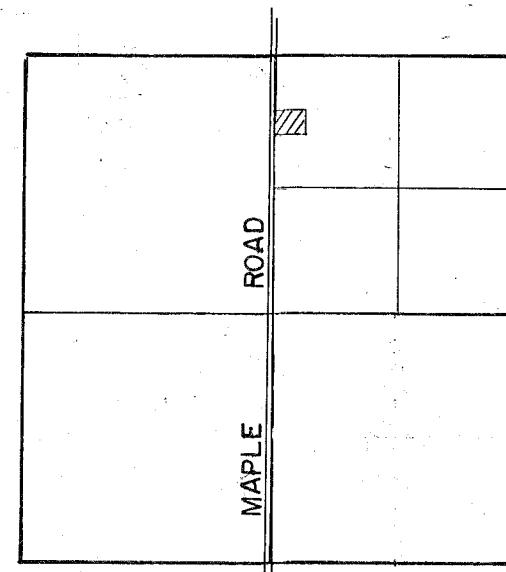

- - 1" IRON PIPE
- ⊗ - NAIL IN ROAD

RECORD # 30128  
LANGLADE COUNTY SURVEYORS OFFICE  
DATE FILED: 5/24/1976 P.T.

DYNAMIC ENGINEERING & SURVEYING		REVISIONS		BY	DATE
SCALE	1" = 100'				
DATE	3-1-76				
DR. N.	JF	CKD.	PV		
AP. VD.	GR				
TITLE	RON ARNDT				NO.
					349

40-105