

DESCRIPTION

A parcel of land located in the Northeast one-quarter (NE $\frac{1}{4}$) of the Southeast one-quarter (SE $\frac{1}{4}$) of Section 27, Town 30 North, Range 11 East, Town of Rolling, Langlade County, Wisconsin.

Commencing at a point on the East line of the Northeast quarter of the Southeast quarter of Section Twenty-seven (27), Township Thirty (30) North, Range Eleven (11) East, 370.5 feet North of the Southeast corner of said forty, thence North along said East line a distance of 458 feet; thence West at right angles to said East line a distance of 228 feet; thence South 458 feet; thence East 228 feet to the place of beginning.

Surveyed by: Gary A. Radtke, RLS Date: 10/28/75

Gary A. Radtke



SUGAR BUSCH RD.

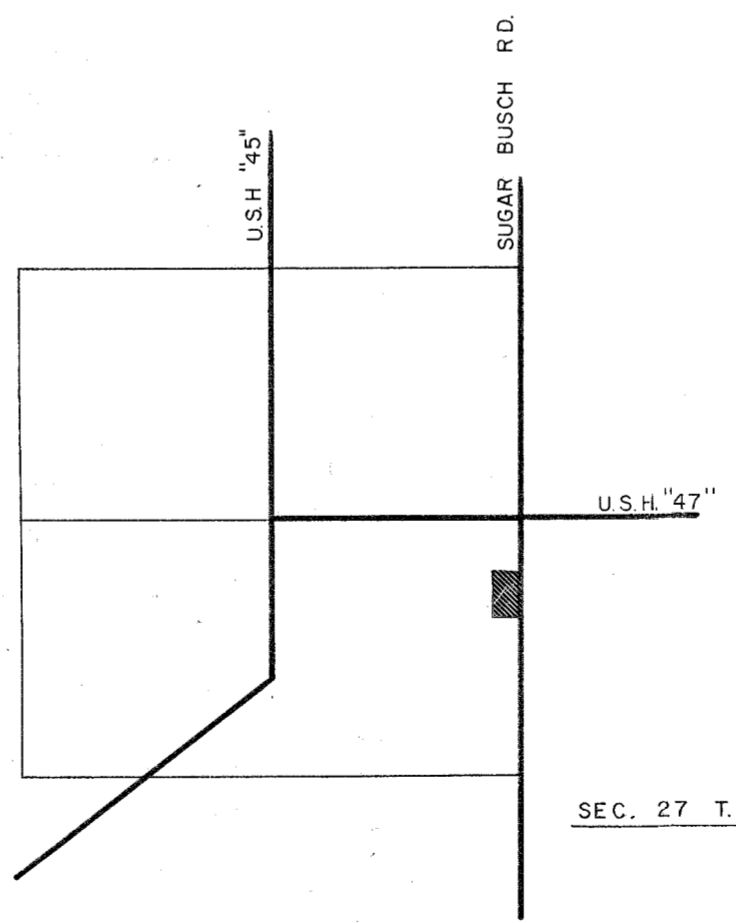

SEC. 27 T. 30N. - R. 11E.

SE CORNER OF THE NE $\frac{1}{4}$ OF THE SE $\frac{1}{4}$ OF SEC. 27

SE CORNER OF SEC. 27

HUGGINS RD.

RECORD # 30146
 LANGLADE COUNTY SURVEYORS OFFICE
 DATE FILED: 5/24/93 BY: D.T.

LANGLADE DEVELOPMENT			
SCALE	REVISIONS	BY	DATE
1" = 60'			
DATE			
10/28/75			
DR. N.	CKD.		
K.R.M.			
AP. VD.			
TITLE	NO.		
RON SCHULTZ	303		