

LEGEND:  
 ○ IRON PIPES FOUND IN PLACE  
 ● 1 1/4" 30" IRON PIPES SET  
 × PK NAIL IN CENTER OF ROADWAY AS TRAVELED  
 (15) LOT NUMBER

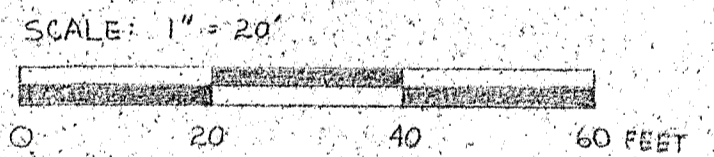

I, WILLIAM F. KELLY, REGISTERED LAND SURVEYOR, CERTIFY THAT I HAVE RETRACED THE BOUNDARIES OF LOTS 15, 14, AND THE S 1/2 OF LOT 13 OF THE ISLE OF PINES PLAT IN SECTION 22 - T34N - R11E ON LOWER POST LAKE IN LANGLADE COUNTY, WIS.

THAT I HAVE FOUND THE DIMENSIONS OF THE LOTS TO BE WITHIN THE LIMITS REQUIRED AT TIME THE PLAT WAS RECORDED.

THAT THE GARAGE ON THE WEST END OF LOT NO. 14 DOES ENCROACH ON THE TOWN ROAD RIGHT OF WAY.

THAT SAID SURVEY WAS MADE AT THE REQUEST OF THE GOEPFERT AGENCY ACTING AS THE AGENT FOR THE RESPECTIVE OWNERS OF LANDS SURVEYED.

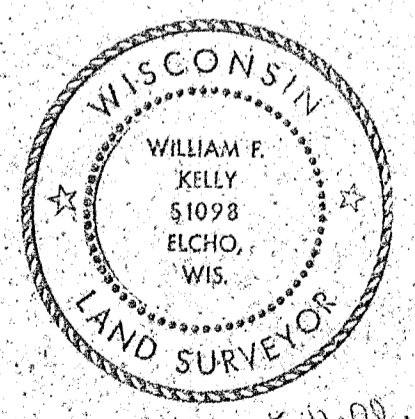

*William F. Kelly*  
6-3-77

BUILDERS SERVICE ENGINEERING DIVISION	
ISLE OF PINES PLAT	
LOTS 15 - 14 & S 1/2 OF 13	
GOEPFERT AGENCY	
DRAWN BY: T. RUSCH	CK. BY W.F. KELLY
SCALE 1" = 20'	DATE 6-3-77
SHEET 1 OF 1	DWG. NO. 175 REV -1
RECORD # 30212	
LANGLADE COUNTY SURVEYORS OFFICE	
DATE FILED 6/28/77 BY DT	