

SOUTH LINE SURVEY OF LOT 2, PLEASANT ACRES SUBDIVISION, LOCATED IN THE S. 1/2 - SE 1/4, SECTION 1, T33N, R10E, TOWN OF UPHAM, LANGLADE COUNTY, WISCONSIN

BEARINGS REFERENCED TO THE EAST LINE LOT 2, PLEASANT ACRES SUBDIVISION ASSUMED TO BEAR S06°38'23"W.

C/L PLATTED PLEASANT ACRES LANE

33'

PLATTED RW LINE

PLATTED RW LINE

C/L PLATTED PLEASANT ACRES LANE

LIST OF STUMPS

- 9 = 3" STUMP
- 10 = 11" STUMP
- 11 = 6.5" STUMP
- 12 = 8.5" STUMP
- 13 = 8" STUMP
- 14 = 5" STUMP
- 15 = 10" STUMP
- 16 = 11" STUMP
- 17 = 5" STUMP
- 18 = 7" STUMP
- 19 = 8" STUMP
- 20 = 4" STUMP
- 21 = 9" STUMP
- 22 = 7" STUMP
- 23 = 4" STUMP
- 24 = 9" STUMP
- 25 = 17" STUMP
- 26 = 3" STUMP
- 27 = 12" STUMP
- 28 = 5" STUMP
- 29 = 11" STUMP
- 30 = 6" STUMP
- 31 = 9" STUMP
- 32 = 4" STUMP
- 33 = 8" STUMP
- 34 = 6" STUMP
- 35 = 10" STUMP
- 36 = 9" STUMP
- 37 = 9.5" STUMP
- 38 = 14" STUMP
- 39 = 6" STUMP
- 40 = 14" STUMP
- 41 = 6" STUMP
- 42 = 7" STUMP
- 43 = 6.5" STUMP
- 44 = 7" STUMP
- 45 = 8.5" STUMP
- 46 = 11.5" STUMP
- 47 = 7" STUMP

- LEGEND**
- FOUND 1" IRON PIPE
 - ⊙ FOUND 1 1/2" IRON PIPE
 - () RECORDED AS

(N 6°38'23"E
219.32'
(220.00')

-2-

SEE DOCUMENT NUMBER 306448

(S 6°38'23"W
220.00'
(220.00')

33'

C/L EXISTING WOODS RD.

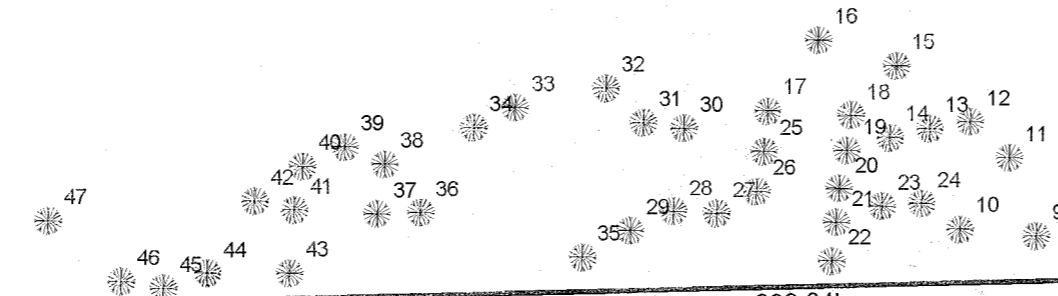

299.84'
S 88°50'18"W
(S 88°42'10"W)
(300.00')

RECORD # 30267
 LANGLADE COUNTY SURVEYORS OFFICE
 DATE FILED: 10/29/07 BY: D. P. LUSBY

I, KEVIN P. BIXBY, HEREBY CERTIFY THAT I HAVE SURVEYED THE ABOVE LINE UNDER THE DIRECTION OF BILL SCOTT AND THAT THE ABOVE MAP IS A TRUE AND CORRECT REPRESENTATION OF THE LINE SURVEYED TO THE BEST OF MY KNOWLEDGE AND BELIEF THAT I HAVE COMPLIED WITH THE PROVISIONS OF AE 7 OF THE WISCONSIN ADMINISTRATIVE CODE.

Kevin P. Bixby
 KEVIN P. BIXBY R.L.S. 2343

09/11/07
 DATE

NOTE: Existing stumps appear to be a former spruce tree. Forester verification is recommended. Tree location on this map is plotted to the lower left of the above shown number system. See table above.

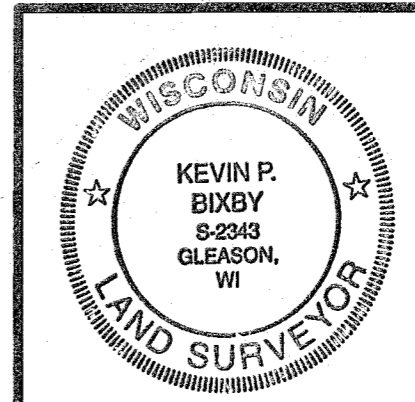

DWG. NO. 0257	BIXBY LAND SURVEYING, INC. RHINELANDER, WISCONSIN
SURVEY FOR WILLIAM SCOTT SUMMIT LAKE, WISCONSIN	
SCALE: 1"=20' DATE: 08/30/04 DWN. BY: K.B.	