

MAP OF SURVEY  
FOR  
DELFIN DIAS

BEING THE S 1/2 OF THE SW 1/4, SEC. 28, T30N, R11E  
TOWN OF ROLLING, LANGLADE COUNTY, WISC.

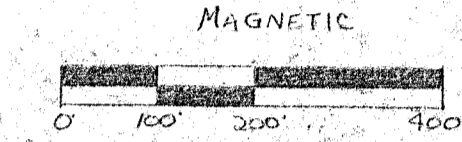

SCALE: 1"=200'

- ELMWOOD ESTATE SUBDIVISION -



LEGEND:  
⊗ BRASS CAP MONUMENT, SET  
⊙ BRASS CAP MONUMENT, EXISTING

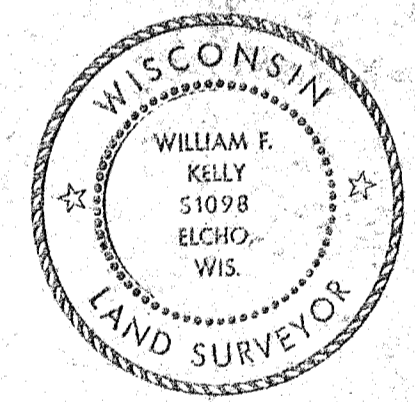

William F. Kelly  
1-8-82

BUILDERS SERVICE ENGINEERING DIVISION	
MAP OF SURVEY	
FOR	
DELFIN DIAS	
DRAWN BY: LISA MEYER	
SCALE 1" = 200'	DATE JAN. 8, 1982
SHEET 1 OF 1	DWG. NO: 864

RECORD # ~~30~~ 30277  
LANGLADE COUNTY SURVEYORS OFFICE  
DATE FILED: 6/4/93 BY: D.T.