

SEC. 1 T. 30N. R. 11E.
TOWN OF ROLLING

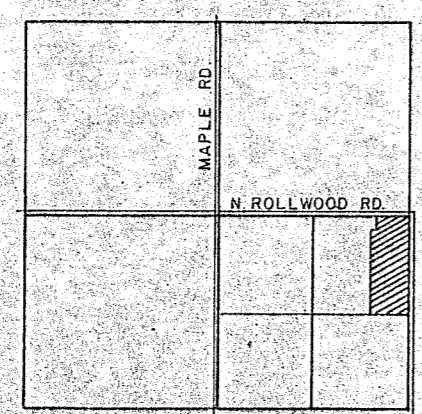

LOCATION SKETCH

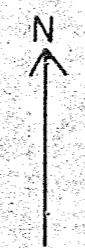

DESCRIPTION

A parcel of land located in the Northeast one-quarter (NE $\frac{1}{4}$) of the Southeast one-quarter (SE $\frac{1}{4}$) of Section 1, Town of Rolling, Langlade County, Wisconsin being more particularly described as follows:

Commencing at the East one-quarter (E $\frac{1}{4}$) of Section 1, T. 30N., R. 11E., Town of Rolling, Langlade County, Wisconsin and the Point of Beginning, Thence S0°-27'-20" E along the East Section Line of said Section 1, 1327.80 feet, Thence N89°-42'-49" W, 581.50 feet along the South Line of the Northeast one-quarter (NE $\frac{1}{4}$) of the Southeast one-quarter (SE $\frac{1}{4}$) of said Section 1, Thence N0°-58'-20" W, 223.97 feet, Thence S90°-00'-00" E, 552.60 feet, Thence N0°-58'-20" W, 432.85 feet to the East-West Center Section Line of said Section 1, Thence N90°-00'-00" E, 577.60 feet along the East-West Center Section Line of said Section 1 to the East one-quarter (E $\frac{1}{4}$) and the Point of Beginning.

LOT 1

Commencing at the East one-quarter (E $\frac{1}{4}$) of Section 1, T. 30N., R. 11E., Town of Rolling, Langlade County, Wisconsin, Thence S0°-27'-20" E along the East Section Line of said Section 1, 33.00 feet, Thence S90°-00'-00" W, 33.00 feet to the South and West Right of Way Line of North Rollwood Road and the Point of Beginning, Thence S90°-00'-00" W along the South Line of North Rollwood Road 504.31 feet, Thence S0°-58'-20" W, 452.85 feet, Thence N90°-00'-00" E, 499.44 feet to the West Right of Way Line of North Rollwood Road, Thence N0°-27'-20" W, 452.80 feet along the West Right of Way Line of North Rollwood Road to the Point of Beginning.

LOT 2

Commencing at the East one-quarter (E $\frac{1}{4}$) of Section 1, T. 30N., R. 11E., Town of Rolling, Langlade County, Wisconsin, Thence S0°-27'-20" E along the East Section Line of said Section 1, 435.80 feet, Thence S90°-00'-00" W, 33.00 feet to the Point of Beginning, Thence S90°-00'-00" W, 499.44 feet, Thence S0°-58'-20" W, 114.15 feet, Thence S90°-00'-00" W, 165.85 feet, Thence S0°-58'-20" W, 165.85 feet, Thence N90°-00'-00" E, 552.99 feet to the West Right of Way Line of North Rollwood Road, Thence N0°-27'-20" W along the West Right of Way Line of North Rollwood Road 280.00 feet to the Point of Beginning.

LOT 3

Commencing at the East one-quarter (E $\frac{1}{4}$) of Section 1, T. 30N., R. 11E., Town of Rolling, Langlade County, Wisconsin, Thence S0°-27'-20" E along the East Section Line of said Section 1, 200.80 feet, Thence S90°-00'-00" W, 33.00 feet to the Point of Beginning, Thence S90°-00'-00" W, 552.99 feet, Thence S0°-58'-20" W, 280.00 feet, Thence N90°-00'-00" E, 550.47 feet to the West Right of Way Line of North Rollwood Road, Thence N0°-27'-20" W along the West Right of Way Line of North Rollwood Road, 280.84 feet to the Point of Beginning.

LOT 4

Commencing at the East one-quarter (E $\frac{1}{4}$) of Section 1, T. 30N., R. 11E., Town of Rolling, Langlade County, Wisconsin, Thence S0°-27'-20" E along the East Section Line of said Section 1, 1,043.80 feet, Thence S90°-00'-00" W, 33.00 feet to the Point of Beginning, Thence S90°-00'-00" W, 550.47 feet, Thence S0°-58'-20" W, 278.12 feet, Thence N89°-42'-49" W, 581.50 feet along the South Line of the Northeast one-quarter (NE $\frac{1}{4}$) of the Southeast one-quarter (SE $\frac{1}{4}$) of said Section 1, to the West Right of Way Line of North Rollwood Road, Thence N0°-27'-20" W, along the West Right of Way Line of North Rollwood Road, 280.84 feet to the Point of Beginning.

I, Gary A. Radtke, Registered Land Surveyor certify that I made such survey and map under the direction of Mr. Ronald [redacted] owner of said land. That the map is a correct representation of all exterior boundaries of the survey.

Dated 01 Nov 76

GARY A. RADTKE S-1248



RECORD # 30280 #5
LANGLADE COUNTY SURVEYORS OFFICE
DATE FILED: 6/4/93 BY: D.T.

DYNAMIC ENGINEERING - SURVEYING			
SCALE	REVISIONS	BY	DATE
1" = 200'			
DATE	10-29-76		
DR. N.	JF	CKD	
APPROV.			
TITLE		NO.	
ARNDT		617	