

LEGEND

- ⊙ 4" iron pipe with brass cap found
- found Bernsten SN-1 nail
- 1" x 30" iron pipe set, marked with steel sign post
- ⊙ 2" alum. pipe with 3 1/4" alum. cap found
- (xxxx) 1930's re-survey data
- County Forest Boundary

Bearings shown are in reference to the computed geodetic bearing between Langlade County Geodetic Control monuments, Kamptzer GPS PS and Kamptzer GPS Azimuth station. Corner forms for all section and quarter section corners shown hereon are on file in the County Surveyors office.

Note: Bearing trees shown are measured to an aluminum nail in a low blaze on the side of the tree. Trees have "Bearing Tree" signs facing the corner and are painted blue.

I, David E. Tlusty, Registered Land Surveyor and Langlade County Surveyor, do hereby certify that, by the direction of the Langlade County Forestry Department, I have made a survey to locate corners and lines of County Forest land as shown hereon, within Section 21, Township 33 North, Range 11 East, Langlade County, Wisconsin. The location of each section and quarter section corner shown is based on open traverse survey work with a Geodimeter total station and electronic data collection.

I further certify that this map is a true and correct representation of said survey, and that this survey is correct to the best of my knowledge and belief.

September 28, 1998
 David E. Tlusty, RLS-1390
 Langlade County Surveyor

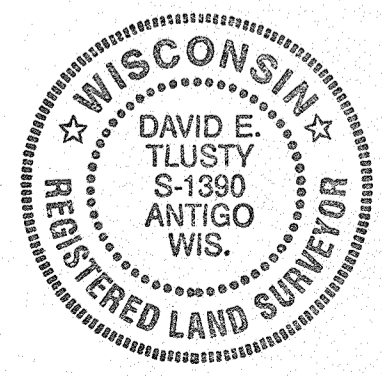

THIS DOCUMENT WAS CREATED ON LANGLADE COUNTY COMPUTER EQUIPMENT THAT WAS PURCHASED WITH THE ASSISTANCE OF A GRANT RECEIVED FROM THE WISCONSIN LAND INFORMATION BOARD.	
LANGLADE COUNTY LAND RECORDS & REGULATIONS DEPARTMENT	
NO.	DATE
DESCRIPTION	BY
REVISIONS	
SCALE:	1" = 400'
DRAWN BY:	D. TLUSTY
REF. FILE:	NOBOKEN
DATE:	08/24/98
TOWN OF:	UPHAM
TOWN CODE:	FB12-71
LOCATION:	
SECTION:	21
TOWNSHIP:	33
RANGE:	11
DWG. #:	FD213311

RECORD # 30360
 LANGLADE COUNTY SURVEYORS OFFICE
 DATE FILED: 9/29/98 BY: D. TLUSTY