

SECTION CORNER  
 33.34 T. 34N. R. 11E. ONEIDA CO.  
 4.3 T. 34N. R. 11E. LANGLADE CO.  
 BRASS CAP MONUMENT FOUND IN PLACE

COUNTY LINE

ONEIDA CO.  
 LANGLADE CO.

1/4 CORNER SECTIONS 3-T. 34N. R. 11E.  
 BRASS CAP MONUMENT FOUND IN PLACE  
 N7°26'10"W - 31.10'

SCALE: 1" = 200'

NOTE: NORTH IS REFERENCED FROM RECORDED DEED OF FIRST ADDITION TO LAKEWOOD PARADISE

DRAWN BY W.F. KELLY  
 DATE: 12/23/77

- LEGEND:
- 1 1/2" x 1/2" IRON PIPE SET
  - BRASS CAP MONUMENT
  - 1 1/4" x 2" IRON PIPE SET
  - ▲ P.K. NAIL SET
  - X RAIL ROAD SPIKE SET
  - CEDAR POST SET

NOTE: SEE INDIVIDUAL MAPS OF LOTS FOR LOCAL DESCRIPTIONS PWS. 307, 308, 309, 310, 311

LOT "A"  
 14.1 ACRES

LOT "B"  
 11.4 ACRES

LOT "D"  
 16.7 ACRES

LOT "C"  
 31 ACRES

E PRATT ROAD

HIGH GROUND

MARSH

SPRUCE SWAMP

HIGH GROUND

POLECREEK CREEK  
 APPROXIMATE

PLAT OF FIRST ADDITION TO LAKEWOOD PARADISE

DESCRIPTION OF EASEMENT ROAD  
 Commencing at the N 1/4 Corner Sect. 3-T. 34N. R. 11E. Thence S89°39'40"W 19.10 feet; thence S7°26'10"E 31.20 feet to the point of real beginning in the center of Pratt Road; thence S87°15'45"W 313.20 feet; thence S85°29'40"W 402.45 feet; thence S57°14'25"W 55.75 feet; thence S22°59'35"W 65.83 feet; thence S13°44'00"W 81.85 feet; thence S2°50'55"W 281.20 feet; thence S83°24'35"W 338.50 feet; thence S55°39'50"W to intersection with the East line Lot "D"

The above describes the center line of a 50 foot wide easement for access to Lots A, B, C, and D as shown on Survey Maps 307, 308, 309, 310, and 311 by W.F. KELLY R.L.S. in DEC. 1977

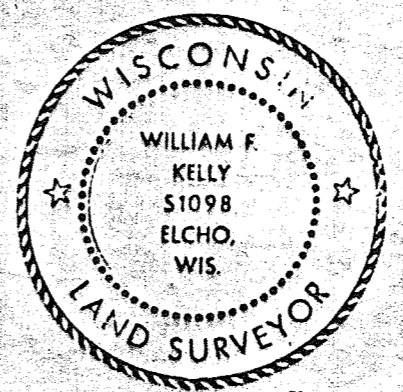

William F. Kelly  
 12-23-77

RECORD # 30527  
 LANGLADE COUNTY SURVEYORS OFFICE  
 DATE FILED: 4/27/05 BY: D. Trusty

BUILDERS SERVICE ENGINEERING DIVISION	
LOTS A-B-C-D - PART G.L. #1 SECT 3 T 34N-R 11E	
M. BLACK	
PRATT ROAD - POST LAKE	
DRAWN BY: W.F. KELLY	DATE 12/23/77
SCALE 1" = 200'	DWG. NO: 307
SHEET 1 OF 5	AGENT: GOEFFERT AGENCY

Consolidated  
 Monica Argonne  
 Al Samz Dan Bobbe  
 (715) 487-5268 (715) 674-2018  
 G4