

PART OF
SW1/4 OF THE SE1/4,
SEC. 18, T34N, R9E,
 TOWN OF PARRISH,
 LANGLADE COUNTY, WISCONSIN

BEARINGS REFERENCED TO THE N-S 1/4 LINE, SECTION 18, RECORDED AS AND ASSUMED TO BEAR N 0°37'23" W

△ = COMPUTED POSITION

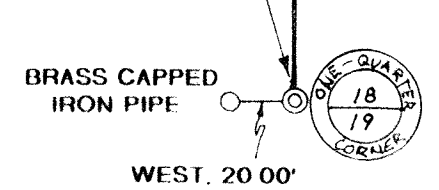

NOTE
 1/4 CORNER POSITION COMPUTED FROM PREV. TIE TO IT AND WIT MONUMENT 20' WEST

RECORD # 30528
 LANGLADE COUNTY SURVEYORS OFFICE
 DATE FILED: 3/5/02 BY: D. TUSTY

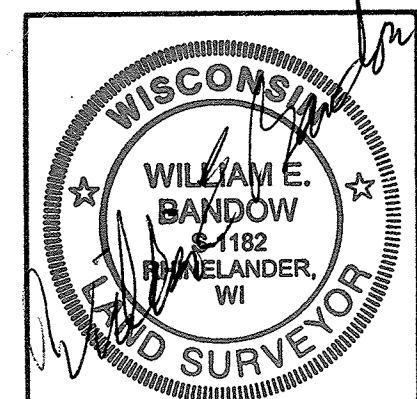

EASEMENT SURVEY FOR
JIM HOLLANDS

SCALE 1" = 60' DATE 13MAR01 DWN. BY KAZ
 DWG. NO. **10,256** GENISOT AND ASSOCIATES, INC.
 RHINELANDER, WIS.