

LOCATED IN PART OF THE SE 1/4 OF THE SW 1/4 SECTION 18,
T34N, R9E, TOWN OF PARRISH, LANGLADE COUNTY, WI.

N

BEARINGS ASSUMED, REFERENCED TO THE N - S 1/4 LINE SECTION 18, AS SHOWN

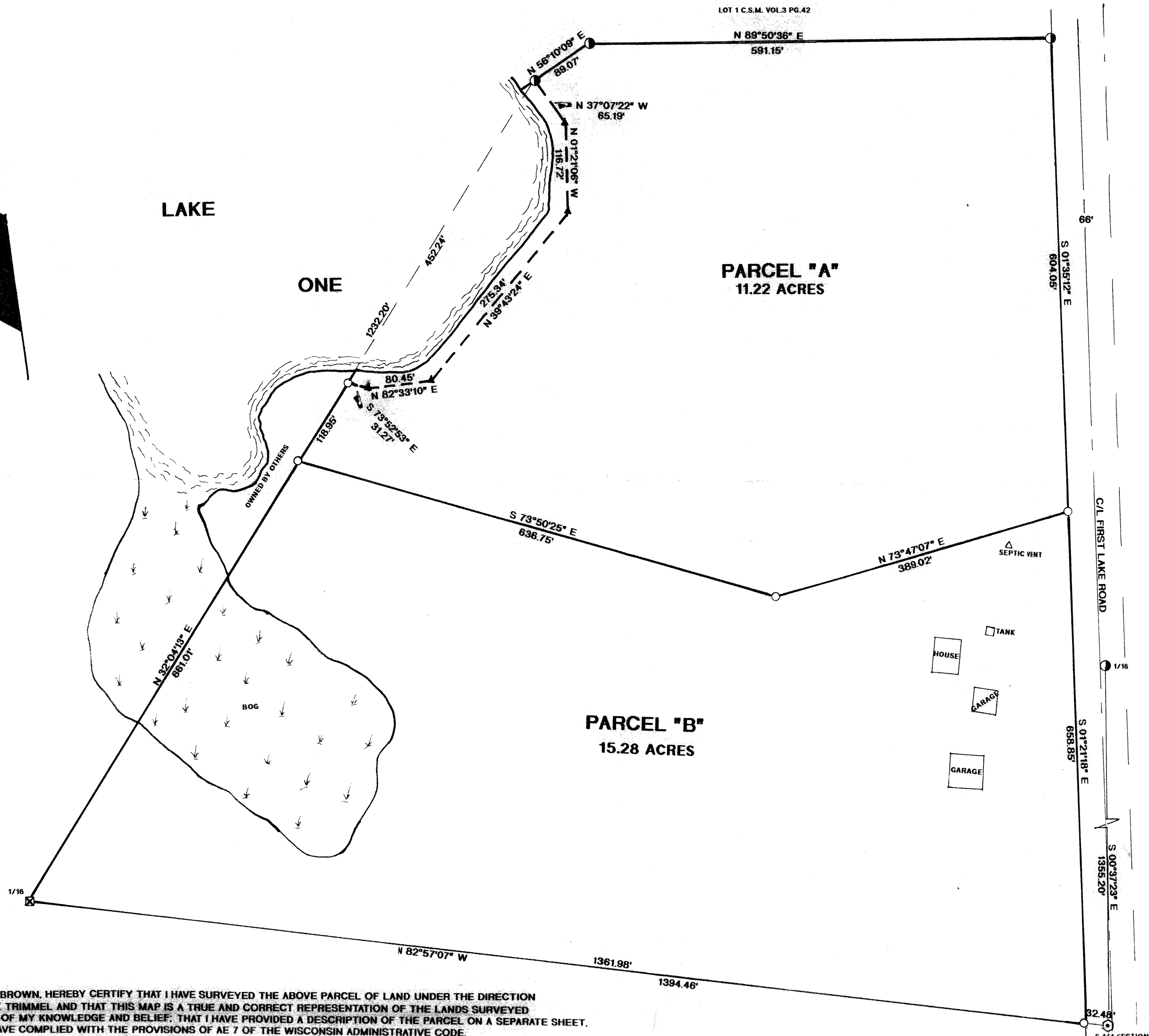

LEGEND:

- SET 1" X 18" IRON PIPE
- FOUND 1 1/4" IRON PIPE
- ⊗ FOUND WOOD POST
- ⊕ FOUND 1" IRON BAR
- ▲ SET 60d SPIKE

RECORD # 30560
LANGLADE COUNTY SURVEYORS OFFICE
DATE FILED: 6/22/06 BY: D. Kelly

NOTE:
LOCATION OF BOG AREA IS APPROXIMATE.

I, RUSSELL F. BROWN, HEREBY CERTIFY THAT I HAVE SURVEYED THE ABOVE PARCEL OF LAND UNDER THE DIRECTION OF MR. FRANK TRIMMEL AND THAT THIS MAP IS A TRUE AND CORRECT REPRESENTATION OF THE LANDS SURVEYED TO THE BEST OF MY KNOWLEDGE AND BELIEF. THAT I HAVE PROVIDED A DESCRIPTION OF THE PARCEL ON A SEPARATE SHEET, AND THAT I HAVE COMPLIED WITH THE PROVISIONS OF AE 7 OF THE WISCONSIN ADMINISTRATIVE CODE.

Russell F. Brown 6/13/06
RUSSELL F. BROWN DATE

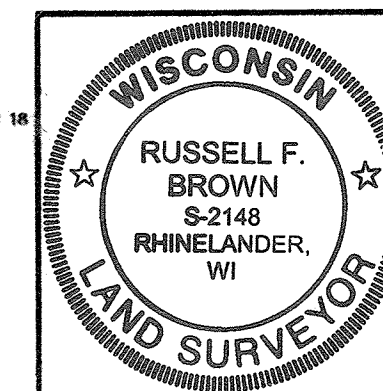

SURVEY FOR
FRANK TRIMMEL

SCALE 1" = 100' DATE 6/9/06 DWN. BY JB
DWG. NO. **10818** GENISOT AND ASSOCIATES, INC.
RHINELANDER, WIS.