

St. Joseph Holy Family Parish Cemetery

Block 4

Part of the Northeast Quarter of the Southwest Quarter of
Section 26, Township 30 North, Range 12 East, Langlade County, Wisc.

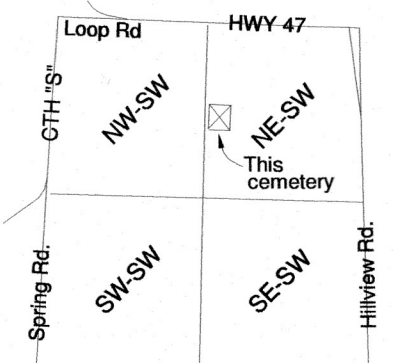

Location sketch
The SW 1/4 of Section 26, T30N, R12E
Not to scale

DESCRIPTION OF BLOCK 4 OF THE ST. JOSEPH HOLY FAMILY PARISH CEMETERY BOUNDARY
Commencing at the West 1/4 corner of Section 26, T.30N., R12E, thence S 87°52'22" E, along the North line of the SW 1/4 of said Section 26, 1129.76 feet to the Northwest corner of the NE-SW of Section 26, thence S 1°36'19" W, along the West line of said NE-SW, 636.65 feet; thence S 85°50'19" E, 33.72 feet to the point of beginning of the parcel herein surveyed, plotted and described; thence S 85°50'19" E, 160.00 feet; thence S 4°09'41" W 132.00 feet; thence N 85°50'19" W, 160.00 feet; thence N 4°09'41" E, 12.00 feet; thence N 85°50'19" W, 8.00 feet; thence N 4°09'41" E 108.00 feet; thence S 85°50'19" E, 8.00 feet; thence N 4°09'41" E, 12.00 feet to the point of beginning.

OWNERS CERTIFICATE
As authorized representatives of St. Joseph Holy Family Parish Cemetery, we certify that we have caused Block 4 of the St. Joseph Family Parish Cemetery to be surveyed, divided, staked and mapped as shown hereon.
Date: 10-25-2022 Art Teal
Date: 10-25-2022 Edward F. Churdimsky
Edward Churdimsky

SURVEYORS CERTIFICATE
I, David E. Tlusty, Wisconsin Professional Land Surveyor, do hereby certify that by the direction of the authorized representatives shown above, and for the St. Joseph Holy Family Parish, I have made a survey and division of Section 4 of the St. Joseph Holy Family Parish cemetery as shown and described hereon.
I further certify that this survey was made in compliance with A-E 7 of the Wisconsin Administrative Code and applicable provisions of Chapter 157.07 of the Wisconsin Statutes. I further certify that this map is a true and correct representation of said survey and that this survey is correct to the best of my knowledge and belief.

October 18, 2022
David E. Tlusty
Wisconsin Professional Land Surveyor S-1390
TLUSTY
S-1390
Deerbrook
WI
LAND SURVEYOR

RECORD # 40220
LANGLADE COUNTY SURVEYORS OFFICE
DATE FILED: 11/9/22 BY: D.T.

Section 26, T30N, R12E
Langlade County Coordinates
NAD83(2011)
Center, 307817.798, 656444.718
S1/4 cor., 305168.240, 656487.210
W1/4 cor., 307905.347, 654087.824
SW cor., 305236.386, 653896.274

Owner: St. Joseph/Holy Family Parish

Owner: Paul Bissonette

West quarter corner,
Section 26-30-12E
Found RR spike of record
Center of Section,
Section 26-30-12E
Position from ties, no
monument set (on bridge deck)

Bearings are Langlade County Coordinate
System grid bearings referenced to the
section lines shown.

- LEGEND**
- 1" (ID) x 24" iron pipe set
 - 1" (ID) x 10" iron pipe set
 - ⊙ corner as described
 - boundary line surveyed
 - - - line not to scale
 - McGee existing gravestone

SE corner, Lot 101
Langlade County Coordinates
NAD83(2011)
N 307079.46
E 655432.06

Owner: Gary & Kathy Waldvogel

West line, East 1/2, SW 1/4 S 1°36'19" W 2660.30'

existing fence

McGee

Devine

Hartman

Tatro

paved roadway

gravel driveway

South St.

2 arbor vitae clusters
on property line

spruce trees

spruce trees

Southwest corner,
Section 26-30-12E
Set Berntsen SN-1 nail

16th corner

South quarter corner,
Section 26-30-12E
Set Berntsen SN-1 nail

S 88°29'36" E 2591.84'

South line of North 50 rods (825')

S 87°52'22" E 187.40'