

THOMAS ERNSTMEYER PLAT OF SURVEY

LOCATED IN PART OF THE SOUTHWEST 1/4 OF THE NORTHEAST 1/4, OF PART OF THE SOUTHEAST 1/4 OF THE NORTHEAST 1/4, OF ALL OF THE NORTHWEST 1/4 OF THE SOUTHEAST 1/4, OF PART OF THE NORTHEAST 1/4 OF THE SOUTHEAST 1/4, OF ALL OF THE SOUTHWEST 1/4 OF THE SOUTHEAST 1/4, OF THE SOUTHEAST 1/4 OF THE SOUTHEAST 1/4 OF SECTION 16, TOWNSHIP 32 NORTH RANGE 10 EAST, TOWN OF PECK, LANGLADE COUNTY WISCONSIN

A parcel of land being part of the Southwest 1/4 of the Northeast 1/4 and part of the Southeast 1/4 of the Northeast 1/4, all of the Northwest 1/4 of the Southeast 1/4, part of the Northeast 1/4 of the Southeast 1/4, all of the Southwest 1/4 of the Southeast 1/4, and part of the Southeast 1/4 of the Southeast 1/4, of Section 16, Township 32 North, Range 10 East, Town of Peck, Langlade County, Wisconsin more particularly described as follows:

Beginning at the South 1/4 Corner of Section 16; thence N 02° 58' 23" W, 3854.83 feet along the North-South 1/4 line of Section 16; thence S 86° 57' 34" E, 1240.59 feet, thence S 20° 09' 01" E, 674.67 feet; thence S 78° 40' 26" W, 5.91 feet; thence S 25° 09' 25" E, 1502.36 feet; thence N 81° 25' 50" E, 799.39 feet to the East line of the Southwest 1/4 of Section 16; thence S 00° 15' 43" W, 2103.45 feet; thence N 85° 50' 56" W, 2692.09 feet along the South line of the Southwest 1/4 of Section 16 to the point of beginning of the parcel herein described.

Said parcel contains 8, 423,092 Square Feet or 193.368 Acres to the Section line of which 288,626 Square Feet or 6.626 Acres is Ormsby Road or McEachern Road R/W, and of which 619,300 Square Feet more or less or 14.22 Acres more or less is covered by pond and river.

Subject to all roadways and easements of record.

Dated this 9th day of April, 2001.

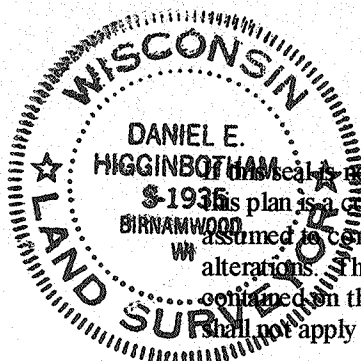

D. Higgins
R.L.S. No. S-1935

Prepared by:
Plover River Land Co., Inc.
P4225 Pineview Rd.
Biramwood, WI 54414

Prepared for:
Tom Ernstmeyer
E2756 Hwy 58
LaValle, WI 53941
Job No. 1393

- 1" I. PIPE FOUND
- 1" X 24" IRON PIPE WEIGHING 1.4 LBS/LINEAL FOOT SET
- () RECORD DATA

BEARING REFERENCED TO THE SOUTH LINE OF THE SE 1/4 OF SEC 16 ASSUMED TO BEAR N 85° 50' 56" W

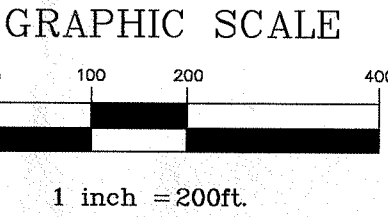

RECORD # 40352 40347
LANGLADE COUNTY SURVEYORS OFFICE
DATE FILED: 2/10/01 BY: D. Trusty
7/31/01

SHEET 1 OF 1	
DRAFTED BY: C. BRINKMEIER	CHECKED BY: D. HIGGINBOTHAM
DATE: APRIL 9 2001	JOB NO.
REVISION DATE:	
PLOVER RIVER LAND CO. INC P4225 PINEVIEW RD BIRAMWOOD WI 54414 (715) 449-2228	