

PLAT OF SURVEY

A parcel of land being part of Government Lot 5 of Section 13 and part of the Northeast 1/4 of the Northwest 1/4 of Section 24, Township 34 North, Range 12 East, Town of Ainsworth, Langlade County, Wisconsin more particularly described as follows:

Commencing at the Southwest Corner of Section 13; thence N 85° 31' 48" E, 1515.02 feet along the South line of the Southwest 1/4 of Section 13 to the Southwest Corner of Government Lot 5, Section 13 and the point of beginning of the parcel herein described; thence N 01° 26' 40" E, 855.47 feet along the West line of Government Lot 5 to a found iron pipe at the Southwest Corner of Lot 1, Volume 4 Certified Survey Maps, Page 282; thence S 88° 46' 45" E, 26.07 feet; thence S 71° 52' 36" E, 185.34 feet along the South line of Volume 4 Certified Survey Maps, Page 282; thence N 64° 31' 52" E, 49.98 feet; thence N 32° 55' 00" E, 192.09 feet along the East line of Lot 3 of Volume 4 Certified Survey Maps, Page 282 to a meander corner of Rolling Stone Lake, said meander corner lies S 32° 55' 00" W, 13 feet more or less from the water's edge of Rolling Stone Lake; thence along the water's edge of Rolling Stone Lake 1070 feet more or less to the Southwesterly line of Lot 5 of said Assessor's Plat; thence S 43° 02' 54" E, 28 feet more or less to a meander corner of Rolling Stone Lake; thence continuing S 43° 02' 54" E, 172.34 feet to the Northwesterly R/W of East Shore Road; thence S 30° 08' 26" W, 42.18 feet; thence S 20° 19' 35" W, 107.85 feet; thence S 10° 00' 40" W, 263.69 feet; thence S 06° 13' 47" W, 268.97 feet; thence S 15° 57' 53" W, 154.59 feet; thence S 20° 53' 17" W, 388 feet more or less to the thread of Pickerel Creek; thence Northwesterly along the thread of Pickerel Creek 890 feet more or less to the South line of Government Lot 5, Section 13; thence S 85° 31' 48" W, 449 feet more or less along the South line of Government Lot 5 to the Southwest Corner thereof and the point of beginning of the parcel herein described.

Said parcel contains 1,373,800 Square Feet or 31.5 Acres more or less to the thread of Pickerel Creek.
Subject to all roadways and easements of record.

PARCEL 2

A parcel of land being all of Lots 2 and 3 of the Assessor's Plat Town of Ainsworth Government Lots 1, 2, 3, 4 and part of Government Lot 5, Section 13 and part of the Northeast 1/4 of the Northwest 1/4 of Section 24 and part of the Southwest 1/4 of the Northwest 1/4 of Section 24, Township 34 North, Range 12 East, Town of Ainsworth, Langlade County, Wisconsin more particularly described as follows:

Beginning at the South 1/4 Corner of Section 13; thence N 03° 45' 39" E, 821.78 feet along the East line of Lots 2 and 3 of the Assessor's Plat to the Southeasterly R/W of East Shore Road; thence S 43° 07' 03" W, 102.74 feet; thence S 34° 56' 54" W, 121.78 feet; thence S 29° 24' 40" W, 112.26 feet; thence S 21° 07' 52" W, 96.68 feet; thence S 10° 03' 46" W, 255.05 feet; thence S 06° 15' 11" W, 273.93 feet; thence S 15° 57' 53" W, 161.71 feet; thence S 20° 53' 17" W, 370 feet more or less to the thread of Pickerel Creek; thence Southeasterly, Southerly, Southwesterly, Southerly and Southeasterly along the thread of Pickerel Creek, 2660 feet more or less to the point where the thread of Pickerel Creek intersects the North-South 1/4 line of Section 24; thence N 09° 03' 03" E, 2480 feet more or less along the North-South 1/4 line of Section 24 to the North 1/4 Corner thereof and the point of beginning of the parcel herein described.

Said parcel contains 1,076,200 Square Feet or 24.7 Acres more or less to the thread of Pickerel Creek.
Subject to all roadways and easements of record.

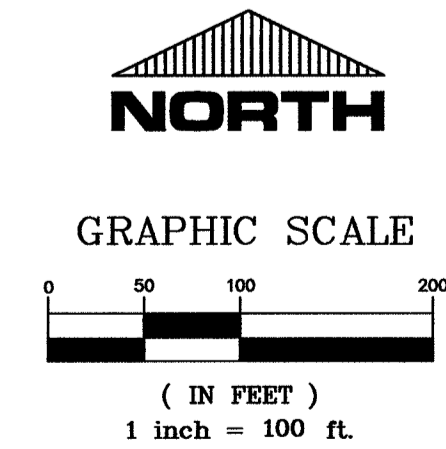
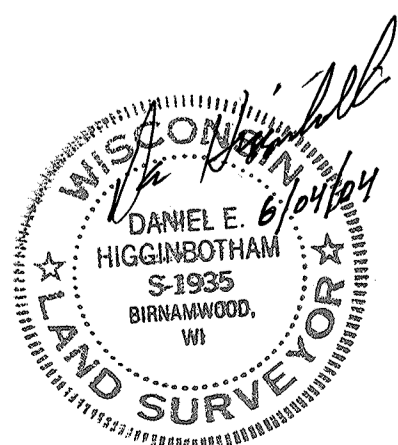

- SEPTIC VENT
- 1-1/4" IRON ROD WEIGHING 3.76 LBS/LINEAL FOOT SET
- 1" X 24" ID IRON PIPE WEIGHING 1.4 LBS/LINEAL FOOT SET
- FOUND 1" PIPE
- FOUND 2" PIPE

SHEET 1 OF 1

DRAFTED BY: MH
CHECKED BY: DH
DATE: 5/28/04
JOB NO.

REVISION DATE:
PLOVER RIVER LAND CO. INC
P4225 PINEVIEW RD BIRNAMWOOD WI 54414
(715)449-2229