

812205

# TOWN OF EVERGREEN CHURCH ON THE HILL CEMETERY

Part of the Northwest Quarter of the Southeast Quarter of Section 16, Township 31 North, Range 13 East,  
Town of Evergreen, Langlade County, Wisconsin.

LOCATION SKETCH  
SECTION 16, T. 31 N., R. 13 E.,  
SCALE: 1" = 2000'

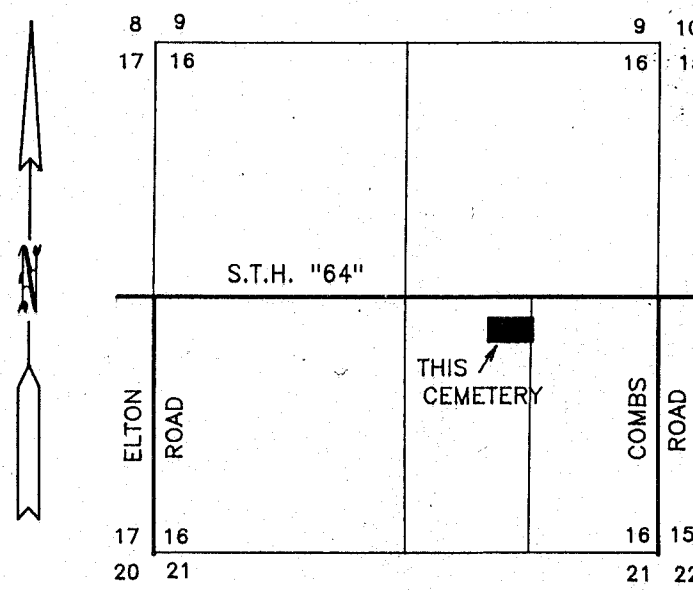

STATE OF WISCONSIN )  
COUNTY OF LANGLADE )  
PERSONALLY CAME BEFORE ME THE ABOVE NAMED  
THOMAS R. ARNOTT, TO ME BE KNOWN TO BE THE  
PERSON WHO EXECUTED THE FOREGOING CERTIFICATE.  
MY COMMISSION EXPIRES 4/27/97  
Mary J. Mauk  
NOTARY PUBLIC, STATE OF WISCONSIN

## SURVEYORS CERTIFICATE

I, THOMAS R. ARNOTT, REGISTERED LAND SURVEYOR, DO HEREBY CERTIFY THAT, BY THE DIRECTION OF THE TOWNSHIP OF EVERGREEN, OWNER, I HAVE SURVEYED AND MAPPED "CHURCH ON THE HILL CEMETERY", LOCATED IN THE NORTHWEST QUARTER OF THE SOUTHEAST QUARTER OF SECTION 16, T. 31 N., R. 13 E., TOWN OF EVERGREEN, LANGLADE COUNTY, WI., DESCRIBED AS FOLLOWS: PARCEL 1 OF CERTIFIED SURVEY MAP #309633, RECORDED IN VOL. 6, ON PAGE 11, LANGLADE COUNTY RECORDS.

I FURTHER CERTIFY THAT: I HAVE COMPLIED WITH THE PROVISIONS OF CHAPTER 157.07 OF THE WISCONSIN STATUTES; THAT THIS MAP IS A TRUE AND CORRECT REPRESENTATION OF SAID CEMETERY SURVEY, AND THAT THIS SURVEY IS CORRECT TO THE BEST OF MY KNOWLEDGE AND BELIEF.

JULY 6, 1994

THOMAS R. ARNOTT S-887

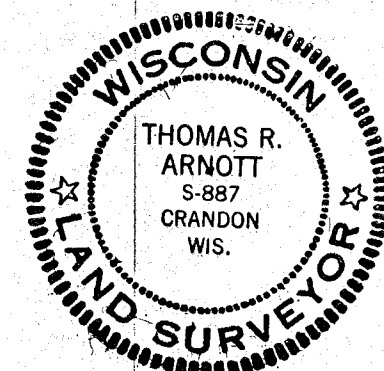

EXISTING CATHOLIC CEMETERY  
N 86°15'59" E 380.87'

C 1/4 corner,  
Section 16

East 1/4 corner,  
Sec. 16-31-13

SCALE: 1" = 20'  
10' 20' 40'

NOTE: THIS CEMETERY PLAT  
SUPERSEDES THE PREVIOUS  
"CHURCH ON THE HILL"  
CEMETERY AS RECORDED ON  
JULY 21, 1994, AS  
DOC. NO. 310171, IN  
LANGLADE COUNTY RECORDS.

## OWNERS CERTIFICATE

THIS IS TO CERTIFY THAT THE TOWN OF EVERGREEN, OWNER OF THE LAND SHOWN ON THIS PLAT, HAS ORDERED SAID LAND TO BE SUBDIVIDED AND MAPPED AS SHOWN. IN TESTIMONY WHEREOF, THE SAID TOWN OF EVERGREEN HAS CAUSED THIS DOCUMENT TO BE SIGNED BY ITS CHAIRMAN AND CLERK.

Emery Farrand  
CHAIRMAN, TOWN OF EVERGREEN

Donald R. Mader  
WITNESS

Marcella Popelka  
CLERK, TOWN OF EVERGREEN

Thomas W. Muroski  
WITNESS

STATE OF WISCONSIN )  
COUNTY OF LANGLADE )  
PERSONALLY CAME BEFORE ME THIS 16<sup>th</sup> DAY OF Nov., 1994  
THE ABOVE NAMED EMERY FARRAND AND MARCELLA POPELKA, TO ME BE KNOWN TO BE THE PERSONS WHO EXECUTED THE ABOVE CERTIFICATE AND ACKNOWLEDGE THE SAME.

MY COMMISSION EXPIRES 4/27/97

Mary J. Mauk  
NOTARY PUBLIC, STATE OF WISCONSIN

## TOWN BOARD RESOLUTION OF APPROVAL

RESOLVED: THAT THE CHURCH ON THE HILL CEMETERY, TOWN OF EVERGREEN, OWNER, IS HEREBY APPROVED BY THE EVERGREEN TOWN BOARD, THIS 16<sup>th</sup> DAY OF Nov., 1994.

Emery Farrand  
EMERY FARRAND, CHAIRMAN, TOWN OF EVERGREEN

I, MARCELLA POPELKA, CLERK OF THE TOWN OF EVERGREEN, LANGLADE COUNTY, WISCONSIN, DO HEREBY CERTIFY THAT THE FOREGOING IS A COPY OF A RESOLUTION ADOPTED BY THE EVERGREEN TOWN BOARD THIS 16<sup>th</sup> DAY OF Nov., 1994.

Marcella Popelka  
MARCELLA POPELKA, CLERK, TOWN OF EVERGREEN

## COUNTY BOARD RESOLUTION OF APPROVAL

WHEREAS, BE IT RESOLVED, BY THE COUNTY BOARD OF LANGLADE COUNTY, WISCONSIN, THAT THE PLAT KNOWN AS CHURCH ON THE HILL CEMETERY, IN THE NW 1/4 SE 1/4 OF SECTION 16, T31N, R13E, TOWN OF EVERGREEN, LANGLADE COUNTY, WISCONSIN, IS HEREBY APPROVED,

Joseph W. Barnett Eugene Kampas

I, NORMAN J. CEJKA, CLERK, LANGLADE COUNTY, WISCONSIN, DO HEREBY CERTIFY THAT THE FOREGOING IS A COPY OF A RESOLUTION ADOPTED BY THE LANGLADE COUNTY BOARD OF SUPERVISORS THIS 13<sup>th</sup> DAY OF December, 1994.

Norman J. Cejka  
NORMAN J. CEJKA, LANGLADE COUNTY CLERK

RECORD # 40504  
LANGLADE COUNTY SURVEYORS OFFICE  
DATE FILED: 12/14/94 BY: D. T. W.

CSM, VOL. 1, PG. 271

N 0°16'55" W 229.13'

UNPLATTED.



312205

RECORDED  
LANGLADE COUNTY, WI.  
RECORDED IN VOL. 6, ON PAGE 11  
AD. VOL. 6, PAGE 11  
Recorded on 7/6/94  
Register of Deeds

TRANSFER FEE  
RECORDING FEE  
GRANTOR  
GRANTEE  
TRACT MICRO

ALL GRAVES MEASURE 5' X 11'

## LEGEND

- iron pipe set
- iron pipe found
- ▲ RR spike found, replaced with 3/4" re-bar
- County monument found.
- Boundary of parcel surveyed.

Assumed bearings referenced to section lines shown.

CHURCH ON THE HILL CEMETERY, SHEET 1 OF 1